

# TERMINATIONS

Type N, DC - 18 GHz, 2 Watts

## SPECIFICATIONS:

Models: TNXXXM, TNXXXF, TNXXXMC, TNXXXFC

**RoHS**  
Compliant

<b>Electrical:</b>	
Frequency Range _____	DC - 18 GHz
Standard Freq. Values _____	6 & 18 GHz
VSWR	
DC - 4 GHz _____	1.10:1 Max.
4 - 8 GHz _____	1.15:1 Max.
8 - 12.4 GHz _____	1.20:1 Max.
12.4 - 18 GHz _____	1.25:1 Max.
Impedance _____	50 Ohms
Input Power _____	2 Watts Avg. @ +25°C
	Derated Linearly to 1 Watt @ +125°C
Peak Power _____	250 Watts Max.
	(5uSec Pulse, .05% Duty Cycle)
Operating Temp Range _____	-65°C to +125°C
Temperature Coefficient _____	±250 ppm/°C
<b>Mechanical:</b>	
Type N Connectors _____	Passivated Stainless Steel
Mates with MILSTD-348	
Conductors _____	Gold Plated Beryllium Copper
Bead Chain _____	Passivated Stainless Steel

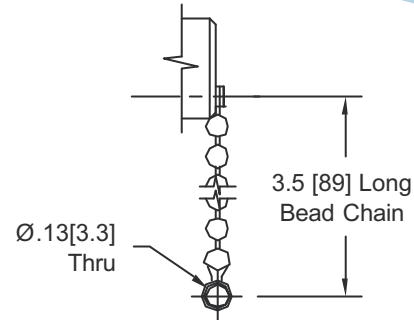

CHAIN DETAIL

Model Number: **TNXXXM**  
Type N Male Connector

Model Number: **TNXXXF**  
Type N Female Connector

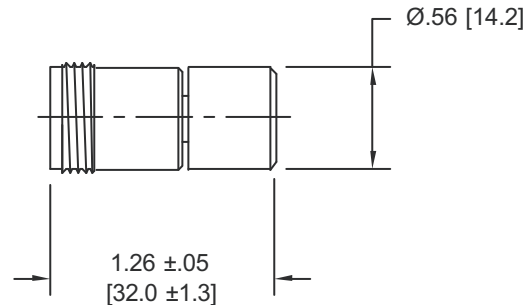
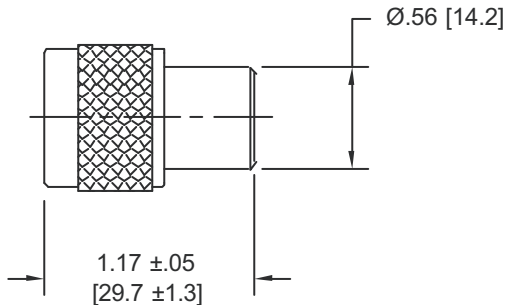

## HOW TO ORDER:

Model Number: **TNXXXYZ**

Frequency Range  
060 = DC - 6 GHz  
180 = DC - 18 GHz

Style  
= No Chain  
C = Chain Included

Connector Configuration  
M = Male  
F = Female

## Ordering Examples:

Model Number: **TN180MC**  
DC - 18 GHz; Type N Male; Chain Included

Model Number: **TN060F**  
DC - 6 GHz; Type N Female; No Chain

Note: Dimensions in Brackets are Expressed in Millimeters and are for Reference Only.  
Design specifications are subject to change without notice.  
Contact factory for technical specifications before purchasing or use.

TN180: REV G



Aeroflex / Inmet, Inc. • 300 Dino Drive, Ann Arbor, MI 48103 • U.S.A.  
888-244-6638 or 734-426-5553 • FAX: 734-426-5557  
www.aeroflex.com/inmet • inmet@aeroflex.com