

Stepper Motor with Gearhead PN I6250

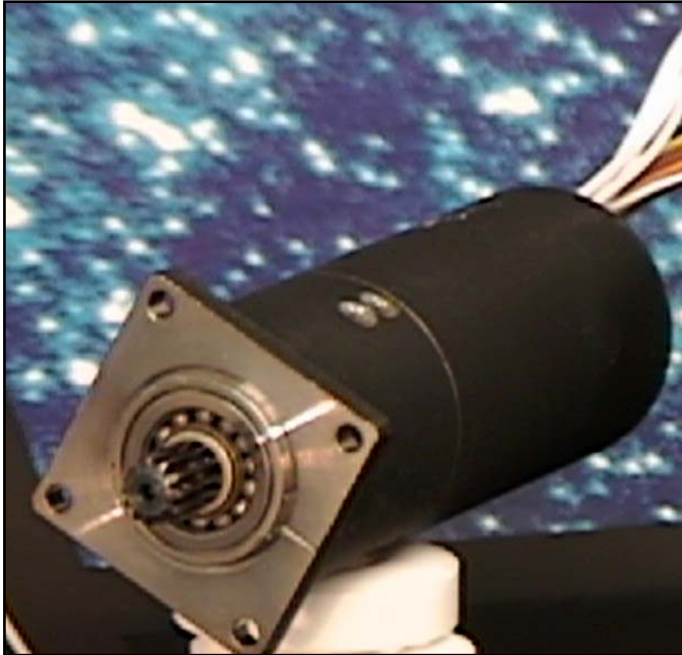

AEROFLEX
A passion for performance.

Specification	Value	Units	Basis
Gear Ratio	21.8:1	ratio	By Design
Output Step Angle	2.06	degrees	Nominal
Running Torque	13	in-oz	Nominal
Holding Torque	24	in-oz	Nominal
Unpowered Torque	2.3	in-oz	Nominal
Backlash	0.25	degrees	Maximum
Weight	4.5	ounces	Nominal

Motor Specification	Value	Units	Basis
Step Angle	45	degrees	Nominal
Step Rate	44	pps	Maximum
Voltage	10	volts DC	Maximum
Power	1.55	watts	Maximum
Phase Resistance	64.6	ohms	Nominal
Phase Inductance	16	mH	Nominal
Phases/Poles	4/8	phases/poles	By Design
Redundant Windings	Yes	windings	By Design

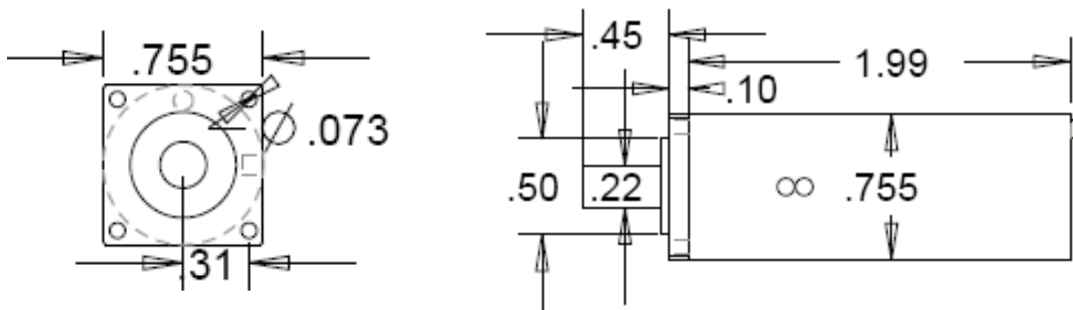

For the very latest specifications visit www.aeroflex.com/Motion