

Stepper Motor with Gearhead PN 16283

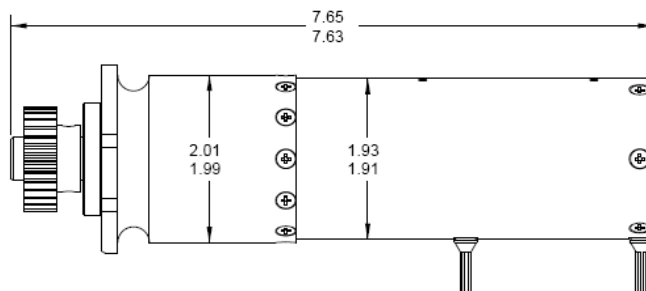

Specification	Value	Units	Basis
Gear Ratio	200:1	ratio	By Design
Output Step Angle	0.225	degrees	Nominal
Running Torque	75.2	in-lb	Nominal
Holding Torque	11.4	in-lb	Nominal
Unpowered Torque	6.4	in-lb	Nominal
Backlash	0.5	degrees	Maximum
Weight	4.4	pounds	Nominal

Motor Specification	Value	Units	Basis
Step Angle	45	degrees	Nominal
Step Rate	100	pps	Maximum
Voltage	25	volts DC	Maximum
Power	3.9	watts	Maximum
Phase Resistance	10	ohms	Nominal
Phase Inductance	25	mH	Nominal
Phases/Poles	2/8	phases/poles	By Design
Redundant Windings	Yes	windings	By Design

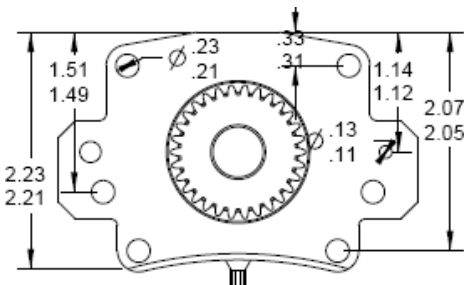

For the very latest specifications visit www.aeroflex.com/Motion